

ARCORA®

www.arcora-group.com

ANIKO 10

SPRAY EXTRACTION MACHINE







Read these instructions carefully before operating the machine!



To obtain the best results from you new appliance, please read and follow these instructions carefully.

-  Always use manufactures recommended cleaning and care products with this machine.
-  Our experience shows that difficulties with the machine and poor cleaning results, are as a direct consequence of using non-suitable cleaning and care products.

Contents

Safety instructions, Safety précautions.....	English 2, 3
Description of pictures, Technical Specification	English 4
Spray extraction operations, Preparatory steps before using the machine.....	English 5
Starting up the machine, Operating procédure.....	English 5
Assembly and application	English 5
Maintenance / servicing, Faults, Final remark.....	English
Environmental protection, Declaration of Conformity.....	English



Safety instructions

- This device is designed for commercial use suitable, for example in hotels, schools, hospitals, Factories, shops, offices and rental shops.
- This equipment is not intended to be used by persons (including children) with restricted physical, sensory or mental abilities or who have no experience and/or knowledge of its use, unless supervised by a person who is responsible for their safety, or they have received instructions from this person on how to use the equipment.
Children should be monitored in order to ensure that they do not play with the equipment.
- Before using, check the data plate on the machine and make sure that the machine is connected to the correeect electrical supply!
- This machine is not suitable for vacuuming dust particles representing a health hazzard.
- Watch out to other persons whilst operating the machine, especially children. Small children must not be permitted to crawl on the dmp carpet.
- Only use manufactures recommended cleaning and care agents, the dilution of each product is printed on the label. Never use cleaning and care agents containing solvents!
- Never vacuum any explosive, flammable, toxic or dangerous substances!
- Do regularly check the electrical cables and connectors for damage!
- Ensure that the cable is not damaged (heat, oil, sharp corners, rough surfaces etc.)!
- **Never** pull or carry the machine by it's electricalcable!
- The machine must be unplugged from the mains when being cleaned or serviced, when parts are being changed or when converting to a different function.
- The machine must not be used if the mains supply cable is not in a serviceable condition.
- **Never** remove the plug with wet hands or by pulling the cable!
- The instructions of the manufacturer must be complied with when replacing the mains supply cable or appliance connectons.
- are to be protected by a circuit breaker type H with a rated current of 10A or a 10A fuse.
- Take care that the mains supply cable is not damaged in any way by being run over, crushed or torn, etc.
- The mains supply cables is to be regulary inspected for signs of damage or aging.
- Faulty mains cables are only to be replaced by PVC flexible sheathed cable 3x1 MM2 H05VV-F according to DIN 58281 / VDE 0281 with variations according to VDE 0700 part 205.



Read these instructions carefully before operating the machine!







Safety instructions





Couplings for mains or appliance connector leads must at least comply with the standards for splashproof models.

- Do pay attention to re-filling procedures, if not, water could enter the vacuum motor and cause damage!
- Do not use the machine in direct proximity of heat sources (fire, gas or electrical stoves etc.)!
- To avoid deformation of the material, never store the machine near radiators etc.!
- Store machine in dry place and keep away from water / sprinklers!
- **Remove filtre on the tube inside of the machine for cleaning, never use the machine without replacing filtre!**
- **For machines using a float assy, check regularly and replace as necessary!**
- **There is a danger of scalding when using manuel nozzles with spraying agent temperatures of over 50°C.**
- Overhauls, including the splicing of spraying agent supply lines and hoses, may only be carried out by certified customer service stations or by specialists in this particular field who are familiar with all the relevant safety précautions.
- Repairs may only be undertaken by authorised service agents!
- Only use original accessories and spare parts!
- If an extension cable is used, make sure that it complies with the relevant safety standards!
- If the machine is stored or transported in temperatures below freezing, empty all water tanks to avoid **frost damage!**

Never operate when:

-  the machine has suffered any external damage
-  cables or hose are damaged
-  the possibility of damage after dropping the machine is given
-  the machine leaks.





Always unplug appliance:

-  before re-filling with water,
-  when it is not in use,
-  before cleaning and maintaining,
-  when leaving unattended.

Safety précautions

Never use the soil extraction method unless you have verified that the textile floor covering and the floor itself will suffer no damage.

Special care is required with:

-  Floors which can be damaged by water (e.g. wood floors and floors of similar material).
-  Carpeting secured with adhesive which is not water résistent.
-  Carpeting which is only partially glued down.
-  Carpets having a backing fabric sensitive to water (e.g. jute or jute blends).
-  Carpets which are not colour-fast. **Test colour fastness in a concealed spot.**

The manufacturer accepts no liability in the case of improper use.

Description of pictures

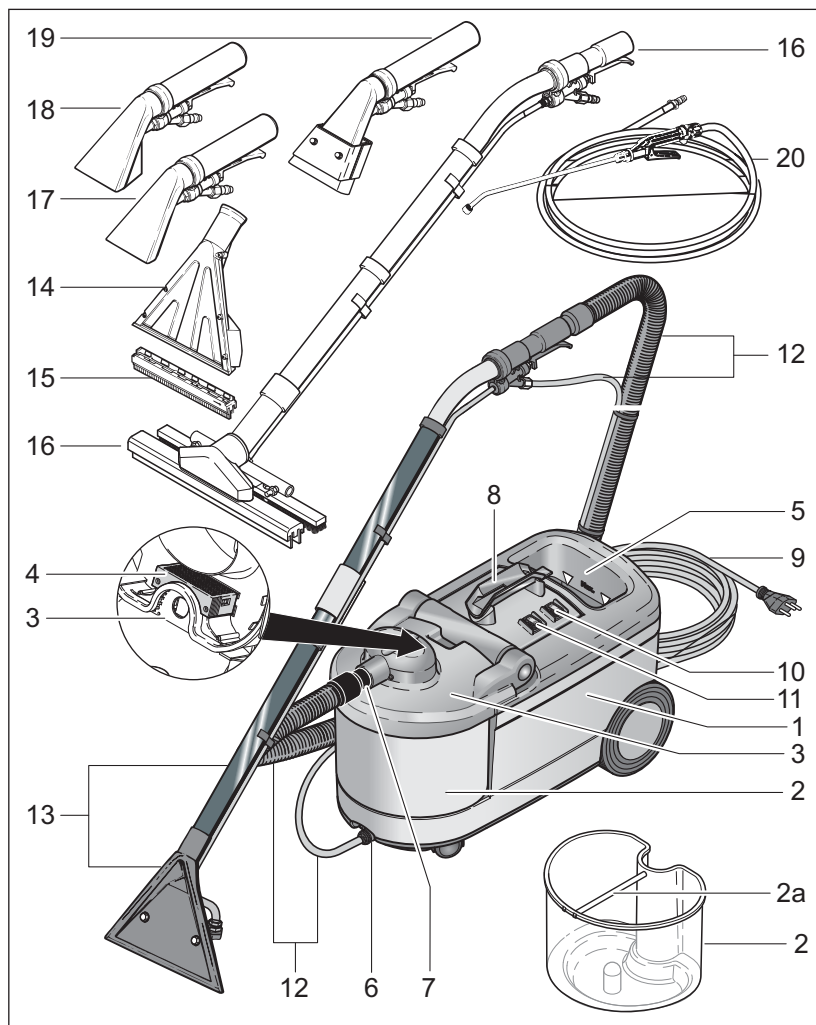

- 1 Machine body / Clean water tank
- 2 Waste water tank
- 2a Handle for lifting waste water tank
- 3 Waste water tank cover
- 4 Filter
- 5 Hopper with level indicator
- 6 Female quick connector for Spray hose
- 7 Connectors for Suction hose
- 8 Handle for lifting machine
- 9 Electr. Connection 7,5 m
- 10 Switch for Suction motor
- 11 Switch for Pump

Standard accessoires

- 12 Spray and suction hose cpl. 2,2 m
- 13 Carpet adapter, 2 jet 26 cm with inox handtube

Special accessories

- 14 Stair tool, 1 jet 23 cm
- 15 Hard floor adapter
- 16 Hard floor adapter, 37 cm
- 17 Upholstery tool 9 cm, PVC
- 18 Upholstery tool 9 cm, Alu
- 19 Wall and ceiling tool 9 cm
- 20 Pre-spraying lance with 10 m hose

Technical Specification

Suction nozzle width	26 cm
Capacity fresh water	10,5 lt
Capacity waste water	9 lt
Voltage	230V / 50Hz
Suction motor	1100 W-220 mbar
Pump pression max.	2,4 bar
Watervolume	1,5 l/min.
Number of spray nozzles	2
Spray- and Suctionhose	2,2 m
Cable length	7,5 m
Weight	14 kg
Measurements l/w/h	65 x 32,5 x 44 cm
Max. températures cleaning	50° C
Sound pressure level	76,5 dB (A)

1. Spray extraction operations

1.1 Preparing the textile floor covering

Vor dem Sprühextrahieren muss der Teppich mit einem Staubsauger gründlich abgesaugt werden.

2. Preparatory steps before using the machine:

- ☞ Only use the machine if the voltage stated on the type plate (number of volts) is identical with the available supply and the connector socket is earthed.
- ☞ Check that the filter is present in the fresh water tank.
- ☞ Mix the cleaning agent in a bucket with cold or hot water (max. 50°C). Dosing: Direct extraction 1% - 3%, pre-spraying 3% - 10%.
- ☞ Connect the pressure hose to the machine at the quick-release coupling. Insert the suction hose in the machine. Assemble suction hose and pressure hose to suction / spray pipe.
- ☞ Check that all switches are off.
- ☞ Plug in the main supply cable.

3. Starting up the machine:

- ☞ Switch on the pressure pump. Do not switch on the pressure pump unless the fresh water tank is full, otherwise the pump will be damaged as it is not designed for dry running.
- ☞ Switch on the suction motor.

4. Operating procedure

4.1 Spray extraction with normal soiling

Pull nozzle slowly backwards (approx. 5 sec./m) with slight pressure on the handpipe and spray/extract in this manner, i.e. spray and pick up immediately. Shortly before completing each phase, shut off the water supply and pick up the water last sprayed on. The next working length should overlap the previous one by 1 - 2 cm.

4.2 With heavy soiling

Carry out spray/extraction a second time, where possible in a crosswise direction. This second cleaning phase is only to be carried out on a totally dry carpet. Note the safety precautions detailed under side English 8.

4.3 Pre-spraying with cleaning solution with heavy soiling

- ☞ **Using suction / spray pipe:**
Pass nozzle fairly quickly over the carpet (approx. 3 sec./m) with the valve open and suction motors switched off.
- ☞ **Using spray lance:**
Connect spray lance to socket for pressure hose. (Max. pressure 5 bar).
- ☞ **Using an external spray device:**
Spray the entire carpet surface, wetting badly soiled areas more thoroughly. Allow the cleaning solution time to act, but never allow it to dry out.
- ☞ Then spray / extract with clean water as described under 4.1.

4.4 With very heavy soiling

Shampoo extremely heavily soiled carpets before using a single brush machine.

4.5 Foaming

When using the spray extraction machine, excess foam may occur in the recovery tank, especially if the carpet has previously been cleaned using a high foam shampoo. If this occurs add defoamer as required to the recovery tank.

4.6 Cleaning areas with difficult access.

Areas of carpeting which are inaccessible to the spray extraction nozzle, e.g. corners, recesses, edges, under radiators or on stairs, can be cleaned easily using the manual extraction nozzle.

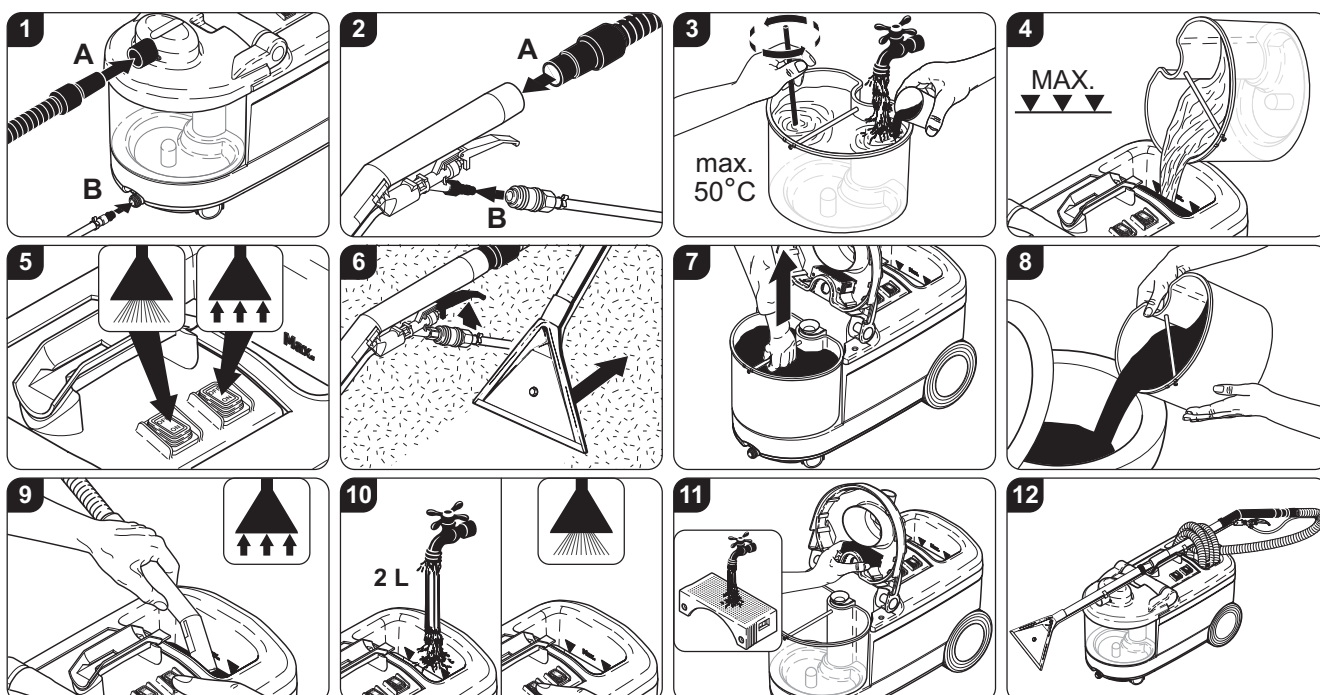

ARCORA®

www.arcora-group.com

Address: Marsstrasse 9, 85609 Aschheim near Munich

E-mail : info@arcora.de

Tel : +49 (0) 89 14 33 29 30

www.arcora-group.com

PRIME
CLEANING
SUPPLIERS



COMPLETE CLEANING SOLUTIONS®

www.primecs.co.za

WESTERN CAPE - 021 551 4570

GAUTENG - 086 111 6008

GARDEN ROUTE - 044 878 1356

EASTERN CAPE | SM SALES - 041 365 2886

MBOMBELA | SM SALES - 013 010 1247

KZN | PAPER LOGIC HYGIENE - 032 944 7750

FREE STATE | IDFS - 051 448 1230

CLEANING CHEMICALS/ DISINFECTANTS ▼ PAPER PRODUCTS/DISPENSERS ▼ CLEANING SUNDRIES

All product names, ® Registered Trademarks are property of their respective owners © 2024 - All Rights Reserved